



FOLIO: AUTO CONSOL 7009-238

-----

SEARCH DATE	TIME	EDITION NO	DATE
-----	----	-----	----
21/2/2023	7:27 AM	-	-

VOL 7009 FOL 238 IS THE CURRENT CERTIFICATE OF TITLE

LAND

----

LAND DESCRIBED IN SCHEDULE OF PARCELS  
LOCAL GOVERNMENT AREA GOULBURN MULWAREE  
PARISH OF GOULBURN COUNTY OF ARGYLE  
TITLE DIAGRAM DP782

FIRST SCHEDULE

-----

NEW SOUTH WALES LAND AND HOUSING CORPORATION

SECOND SCHEDULE (0 NOTIFICATIONS)

-----

NIL

NOTATIONS

-----

UNREGISTERED DEALINGS: NIL

SCHEDULE OF PARCELS

-----

LOTS 15-18 IN DP782.

\*\*\* END OF SEARCH \*\*\*



FOLIO: AUTO CONSOL 7009-238

-----

SEARCH DATE	TIME	EDITION NO	DATE
-----	----	-----	----
21/2/2023	7:27 AM	-	-

VOL 7009 FOL 238 IS THE CURRENT CERTIFICATE OF TITLE

LAND

----

LAND DESCRIBED IN SCHEDULE OF PARCELS  
LOCAL GOVERNMENT AREA GOULBURN MULWAREE  
PARISH OF GOULBURN COUNTY OF ARGYLE  
TITLE DIAGRAM DP782

FIRST SCHEDULE

-----

NEW SOUTH WALES LAND AND HOUSING CORPORATION

SECOND SCHEDULE (0 NOTIFICATIONS)

-----

NIL

NOTATIONS

-----

UNREGISTERED DEALINGS: NIL

SCHEDULE OF PARCELS

-----

LOTS 15-18 IN DP782.

\*\*\* END OF SEARCH \*\*\*



FOLIO: AUTO CONSOL 7009-238

-----

SEARCH DATE	TIME	EDITION NO	DATE
-----	----	-----	----
21/2/2023	7:27 AM	-	-

VOL 7009 FOL 238 IS THE CURRENT CERTIFICATE OF TITLE

LAND

----

LAND DESCRIBED IN SCHEDULE OF PARCELS  
LOCAL GOVERNMENT AREA GOULBURN MULWAREE  
PARISH OF GOULBURN COUNTY OF ARGYLE  
TITLE DIAGRAM DP782

FIRST SCHEDULE

-----

NEW SOUTH WALES LAND AND HOUSING CORPORATION

SECOND SCHEDULE (0 NOTIFICATIONS)

-----

NIL

NOTATIONS

-----

UNREGISTERED DEALINGS: NIL

SCHEDULE OF PARCELS

-----

LOTS 15-18 IN DP782.

\*\*\* END OF SEARCH \*\*\*



FOLIO: AUTO CONSOL 7009-238

-----

SEARCH DATE	TIME	EDITION NO	DATE
-----	----	-----	----
21/2/2023	7:27 AM	-	-

VOL 7009 FOL 238 IS THE CURRENT CERTIFICATE OF TITLE

LAND

----

LAND DESCRIBED IN SCHEDULE OF PARCELS  
LOCAL GOVERNMENT AREA GOULBURN MULWAREE  
PARISH OF GOULBURN COUNTY OF ARGYLE  
TITLE DIAGRAM DP782

FIRST SCHEDULE

-----

NEW SOUTH WALES LAND AND HOUSING CORPORATION

SECOND SCHEDULE (0 NOTIFICATIONS)

-----

NIL

NOTATIONS

-----

UNREGISTERED DEALINGS: NIL

SCHEDULE OF PARCELS

-----

LOTS 15-18 IN DP782.

\*\*\* END OF SEARCH \*\*\*

JP 782

STATUTORY DECLARATION.

I RICHARD LENNON MURRAY, of SYDNEY, SURVEYOR, specially licensed under the Real Property Act do hereby solemnly and sincerely declare that the boundaries and measurements of the plan of *subdivision of Portions 77, 78, 79, 80 & 81 Parish of Goulburn County Argyle*

hereto annexed and the said plan and supervision.

said Act, and that der my immediate

And I make by virtue of of Her present "Affirmations" "South Wales" "voluntary an

DECLARED at *Sydney* this *9<sup>th</sup>* day of *December* 188*1* before me.

*R. L. Murray*

*Geo. Pallatino*

G. H. Lees, Printer and Rubber Stamp Maker, 124 Pitt Street, Sydney.

(9.)

PX

PX

782

782

DP 782

51  
24/1/81

# PLAN OF SUBDIVISION

## SUBURBAN PORTIONS 77, 78, 79, 80 & 81.

at **GOULBURN**  
Parish of Goulburn County of Argyle  
Scale one chain to one inch

STANDARD PREPARED

"A"  
This is the plan referred to  
in declaration of J. J. Murray  
made before me this day.  
J. J. Murray  
Goulburn 1881

All distances in links

2 2 0	Suburban Portion 77	Grant to Owen Turner	23 <sup>rd</sup> Sept 1868	Vol: 73	fol: 202.
3 2 7	78		23 <sup>rd</sup>	1868	73 - 203
3 0 12	79		23 <sup>rd</sup>	1868	73 - 204
2 2 24	80		23 <sup>rd</sup>	1868	73 - 205
2 0 36	81		10 <sup>th</sup> June	1873	162 - 98

782

COPY MADE  
EXAMINED  
J. M. S. 24.3.88  
J. J. P.

Goulburn Soap Company owners  
Unoccupied



Owned by  
H. Saunders  
Occupied by  
Geo. Wilkie

Thereby certify that the above Diagram is correct  
for the purposes of the Real Property Act

J. L. Murray  
Licd. Surveyor

Amended by  
W. C. Cooper

D.P. 782  
Sht. 1/2

*Ph. of Goulburn Co. of Argyle*

Scale: One chain to one inch.

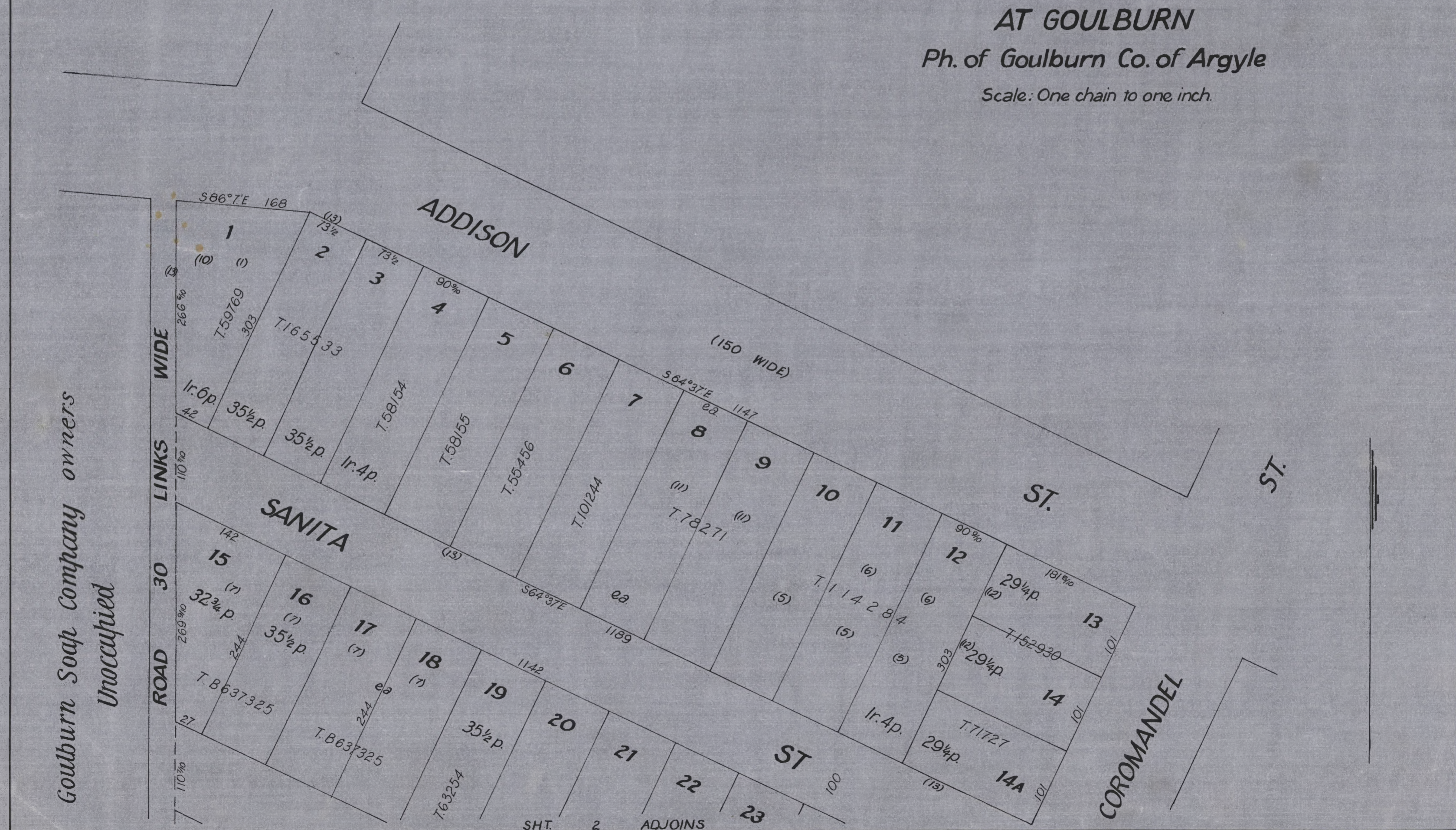

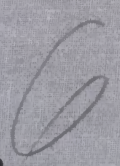

6

6

6

6



CONVERSION TABLE ADDED IN  
REGISTRAR GENERAL'S DEPARTMENT

DP 782		SH 1/2	
LINKS		METRES	
13		2.615	
27		5.43	
30		6.035	
42		8.45	
73.5		14.785	
90.9		18.285	
100		20.115	
101		20.32	
110.7		22.27	
142		28.565	
150		30.175	
168		33.795	
181.8		36.57	
244		49.085	
266.6		53.63	
269.9		54.3	
303		60.95	
1142		229.73	
1147		230.74	
1189		239.19	
AC RD P		SQ M	
- - 26 1/4		663.9	
- - 29 1/4		739.8	
- - 32 3/4		828.3	
- - 35 1/2		897.9	
- 1 4		1113	
- 1 6		1163	



CONVERSION TABLE ADDED IN  
REGISTRAR GENERAL'S DEPARTMENT

DP 782		SH 2/2	
LINKS		METRES	
10		2.01	
27		5.43	
30		6.035	
38.6		7.765	
46.5		9.355	
81.3		16.355	
81.6		16.415	
81.75		16.445	
90.9		18.285	
100		20.115	
101		20.32	
101.3		20.38	
110.7		22.27	
162		32.59	
181.25		36.46	
181.8		36.57	
244		49.085	
245		49.285	
271		54.52	
303.9		61.13	
304.2		61.2	
304.4		61.24	
304.6		61.28	
305		61.36	
305.4		61.44	
305.8		61.52	
335.3		67.45	
675		135.79	
818		164.56	
865		174.01	
980		197.14	
1027		206.6	
1395		280.63	
AC RD P		SQ M	
- - 23 1/2		594.4	
- - 23 3/4		600.7	
- - 29 1/4		739.8	
- - 35 1/2		897.9	
- 1 3/4		1031	
- 1 4		1113	
- 1 4 1/4		1119	
- 1 13 1/4		1347	